

## 25A / 32A

### ► DIN-RAIL IN-PANEL MOUNTING

 Technical Info (p. 192)

#### PADLOCKABLE PRESENTATION

Grey Handle  
Part Number



0174005

**25 A**  
3P  
3P + NC/NO  
4P neutral on left  
4P + NC/NO

**0174005**  
**0174015**  
**0174025**  
**0174035**

**32 A**  
3P  
3P+NC/NO  
4P neutral on left  
4P + NC/NO

**0174105**  
**0174115**  
**0174125**  
**0174135**

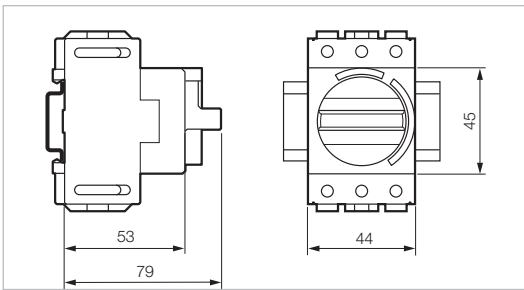

#### COMPONENTS AND ACCESSORIES

Part Number



0172000

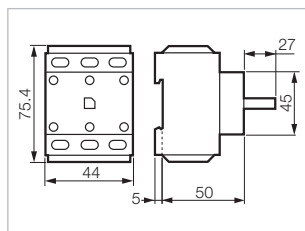

**3-pole switch body without handle**

25 A  
32 A

**0172000**  
**0172100**

**Additional pole**

25 A  
32 A

**0172075**  
**0172175**

**Neutral pole**

25 A  
32 A

**0172065**  
**0172165**

**Junction block**

Ground or Neutral

**0172185**

**Auxiliary contact**  
NC/NO

**0172179**



0172065

0172185

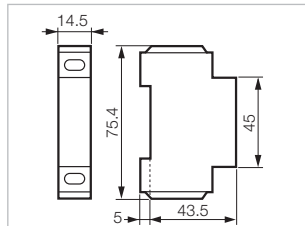

# Technical Specifications

## ▶ GENERAL

| Characteristics   | 25 A    | 32 A    | 50 A    | 63 A    | 80 A    | 100 A   |
|---|---------|---------|---------|---------|---------|---------|
| <b>UL/cUL</b> - suitable as motor disconnect                        |         |         |         |         |         |         |
| > Rated voltage (V)   | 600     | 600     | 600     | 600     | 600     | 600     |
| > General Use Current (A)   | 25      | 32      | 50      | 63      | 80      | 100     |
| > Motor Ratings (hp)  |         |         |         |         |         |         |
| 1 x 120 V   | 0.75    | 1       | 1.5     | 3       | 3       | 5       |
| 1 x 240 V   | 1.5     | 2       | 3       | 5       | 10      | 10      |
| 1 x 277 V   | 2       | 3       | 5       | 7.5     | 10      | 15      |
| 3 x 120 V   | 1.5     | 2       | 3       | 5       | 7.5     | 10      |
| 3 x 240 V   | 3       | 5       | 7.5     | 10      | 20      | 25      |
| 3 x 480 V   | 7.5     | 10      | 15      | 20      | 40      | 50      |
| 3 x 600 V   | 7.5     | 10      | 15      | 20      | 40      | 50      |
| > Auxiliary Blocks  |         |         |         |         |         |         |
| NO/NC   | A600    |         |         |         |         |         |
| Early Make  | B300    |         |         |         |         |         |
| Early Break   | B300    |         |         |         |         |         |
| > Wire Guage (AWG)  |         |         |         |         |         |         |
| 3-Pole Body, Additional Pole,<br>Late Break Neutral, Junction Block | 8 - 14  | 8 - 14  | 4 - 14  | 4 - 14  | 1 - 14  | 1 - 14  |
| Auxiliary Contacts  | 14 - 18 | 14 - 18 | 14 - 18 | 14 - 18 | 14 - 18 | 14 - 18 |
| > Short Circuit Rating  |         |         |         |         |         |         |
| Fuse Type K5 (A)  | 5000    | 5000    | 5000    | 5000    | 5000    | 10000   |
| Fuse Size (A)   | 40      | 40      | 80      | 80      | 125     | 125     |
| Rated break capacity  | 330     | 330     | 800     | 800     | 800     | 800     |

# Technical Specifications

## ► GENERAL

| Characteristics   | 25 A | 32 A | 50 A | 63 A | 80 A | 100 A |
|---|------|------|------|------|------|-------|
| <b>IEC</b>  |      |      |      |      |      |       |
| > Rated insulation voltage $U_i$ (V)  | 690  | 690  | 690  | 690  | 690  | 690   |
| > Conventional free air thermal current $I_{th}$<br>Uninterrupted rated current $I_u$ (A)       | 25   | 32   | 50   | 63   | 80   | 100   |
| > Conventional enclosed thermal current $I_{the}$ (A)   | 20   | 25   | 40   | 50   | 63   | 80    |
| > Rated impulse withstand voltage (overvoltage category III - pollution degree 3 $U_{imp}$ (kV) | 6    | 6    | 6    | 6    | 6    | 6     |
| > Rated operating current $I_e$ (A)<br>AC - 21 A/22 A Conform to IEC 60947-3                    | 25   | 32   | 50   | 63   | 80   | 100   |
| > Rated operating power (kW)  |      |      |      |      |      |       |
| AC 23 A   |      |      |      |      |      |       |
| 3 x 230 V   | 5.5  | 5.5  | 15   | 15   | 18.5 | 22    |
| 3 x 400 V   | 7.5  | 11   | 18.5 | 22   | 30   | 37    |
| 3 x 500 V   | 7.5  | 11   | 22   | 30   | 37   | 45    |
| 3 x 690 V   | 7.5  | 11   | 18.5 | 22   | 22   | 30    |
| AC 3  |      |      |      |      |      |       |
| 3 x 230 V   | 4    | 4    | 7.5  | 11   | 15   | 18.5  |
| 3 x 400 V   | 5.5  | 7.5  | 15   | 18.5 | 22   | 30    |
| 3 x 500 V   | 5.5  | 7.5  | 15   | 22   | 30   | 37    |
| 3 x 690 V   | 5.5  | 7.5  | 15   | 18.5 | 18.5 | 22    |
| > Make - break characteristics ( $A_{eff}/400$ V)   |      |      |      |      |      |       |
| Rated make capacity   | 710  | 710  | 1270 | 1270 | 1970 | 1970  |
| Rated break capacity  | 330  | 330  | 800  | 800  | 800  | 800   |
| > Short circuit characteristics   |      |      |      |      |      |       |
| Rated short term withstand current $I_{cW}$ ( $A_{eff}/400$ V/1 s)                              | 350  | 430  | 500  | 760  | 1100 | 1500  |
| Rated short circuit make capacity $I_{cm}$ (kA peak/400 V)                                      | 1    | 1    | 1.8  | 1.8  | 2.8  | 2.8   |
| Short circuit current (kA $_{eff}/400$ V)   | 10   | 10   | 10   | 10   | 10   | 10    |
| with fuse gI/gG (A)   | 25   | 32   | 50   | 63   | 80   | 100   |



# Technical Specifications

## ► ENCLOSURES

| Characteristics                        | 150x100x96   | 220x150x100                                    | 220x150x100                                    | 220x150x100                                    | 220x150x100                                    | 300x200x100                                    |
|--|--|--|--|--|--|--|
| > Rating                               | 25 and 32 A<br>3P to 4P<br>+NC/NO  | 25 and 32 A<br>6P and 6P<br>+NC/NO             | 50 and 63 A<br>3P to 4P<br>+NC/NO              | 50 and 63 A<br>6P and 6P<br>+NC/NO             | 80 and 100 A<br>3P and 3P<br>+NC/NO            | 80 and 100 A<br>4P to 6P<br>+NC/NO             |
| > Cable inputs                         | 2 x 2 PG 16<br>OR 2 x 2 M25  | 2 x 2 PG 21                                    | 2 x 2 PG 21                                    | 2 x 2 PG 29                                    | 2 x 2 PG 29                                    | 2 x 2 PG 21<br>2 x 2 PG 29                     |
| > Ø knockouts (mm)                     | PG 16: 22.5<br>ISO M25: 25   | 28.5   | 28.5   | 37.5   | 37.5   | 37.5 and 28.5                                  |
| > No. of knockouts<br>(top and bottom) | 2  | 2  | 2  | 2  | 2  | 4  |
| > Panel mount                          | by 2 screws  | by 4 screws                                    | by 4 screws                                    | by 4 screws                                    | by 4 screws                                    | by 4 screws                                    |
| > Base/cover assembly                  | by 1 screws<br>self-tapping<br>stainless steel   | by 4 screws<br>self-tapping<br>stainless steel | by 4 screws<br>self-tapping<br>stainless steel | by 4 screws<br>self-tapping<br>stainless steel | by 4 screws<br>self-tapping<br>stainless steel | by 6 screws<br>self-tapping<br>stainless steel |
| > Switch/base assembly                 | on 35 mm DIN rail (this rail is notched for positioning the switch)  |  |  |  |  |  |
| > Handles mounting                     | screwing on shaft pre-pierced cover  |  |  |  |  |  |
| > Insulation                           | Class II installed (provided that the correct insulation plugs are used with the enclosure)  |  |  |  |  |  |
| > Impact withstand                     | IK07   |  |  |  |  |  |
| > Flameproof                           | 650°C  |  |  |  |  |  |
| > Protection rating                    | IP 66  | IP 40 (IP 65 upon request)                     |  |  |  |  |
| > Contact operating diagram            |  |  |  |  |  |  |
| > Switch padlocking                    | In general: up to 3 padlocks ø 4 to 8 mm<br>Switch with 1 auxiliary contact NC/NO: up to 3 padlocks ø 6 to 8 mm<br>Modular presentation: 1 padlock ø 6 to 8 mm |  |  |  |  |  |

# Technical Specifications

## ► MOUNTING - PANEL DRILLING

### Panel/Door Handle Mounting

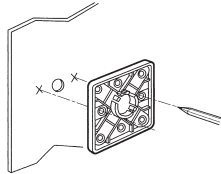
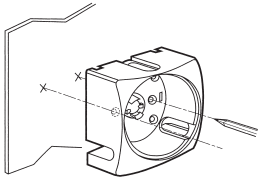

25A/32A

50A/63A/80A/100A

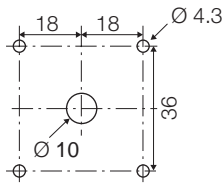
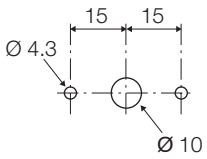

### Ø22 Single Hole Mounting

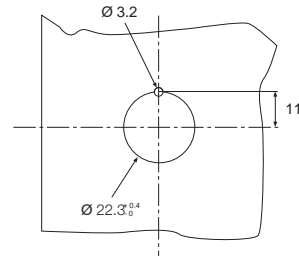

### Door Interlock System

#### Short or Long Metal Shaft Version

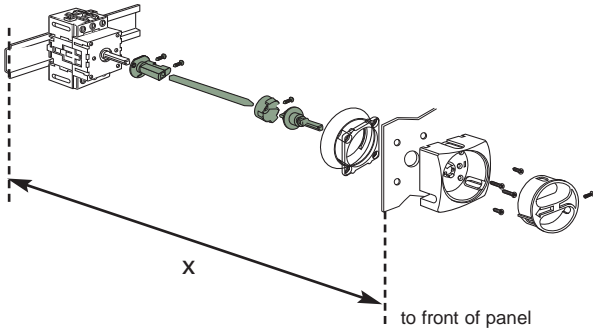

#### No Metal Shaft Version

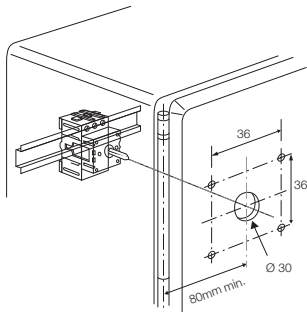
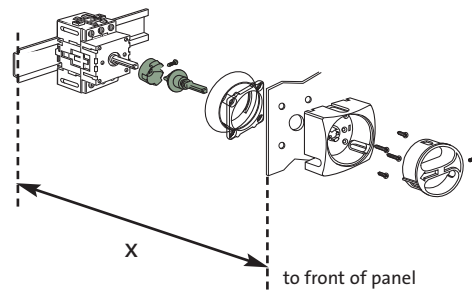

Minimum Distance to Hinge

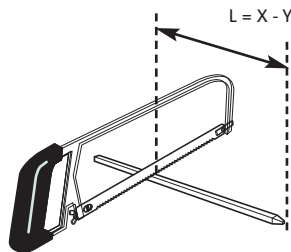

|            | X             |                  |                 | Y      |
|------------|---------------|------------------|-----------------|--------|
|            | without shaft | with short shaft | with long shaft |        |
| 25A / 32A  | 86 - 100 mm   | 125 - 250 mm     | 125 - 400 mm    | 92 mm  |
| 50A / 63A  | 96 - 110 mm   | 135 - 260 mm     | 135 - 410 mm    | 102 mm |
| 80A / 100A | 106 - 120 mm  | 145 - 270 mm     | 145 - 420 mm    | 112 mm |