

IP67 rated DIN valve connector with improved strain relief. Cable retention force increased up to 20% over internal nut style. Enlarged cable range that covers the PG9 and PG11 internal thread connectors cable range.

Specifications

ELECTRICAL

Max. Current 16.0A
Contact Resistance: ≤15milliohms max.
Insulation Resistance:
100Megohms min.
Max. Conductor: 1.50mm² / 16AWG

MECHANICAL

Insertion and Withdrawal Force:
2+GND ≤ 60N

CERTIFICATION

UL recognized, cURus marked, file E218123 (product available upon request or specific part number)

PHYSICAL

Durability: min. 50 cycles
Contact Area: Silver
Solder Tail Area: Silver
Operating Temperature with:
Nitrile Rubber (NBR) Gasket:
-40° +90°C
Silicone Gasket: -40° +125°C
Cable Diameter Range: 4.00-9.00mm
Live Contact Distance: 11.00mm

ENVIRONMENTAL

IP67 Sealing Protection

Non Electronic

C22 2 00 N 0 R **

SERIES

C22=External Thread Form Industrial

POLES

2=2Poles+Ground

THREAD

00=External Thread

COVER COLOR

N=Black Cover G=Gray Cover

W=V0 Black Cover (only with UL listed connectors)

GROUND POSITION

0=Unmounted 2=H12 6=H6

SCREW & GASKET

R=Integrated NBR Gasket & IP67 Screw, S=Integrated Silicone Gasket & IP67 Screw

PACKAGING STYLE

no digit=Single Bag Unmounted, SN=Bulk Pack Mounted, CN=Bulk Pack Unmounted

IP67

Electronic

S22 2 00 T C4 2 0 R **

SERIES

S22=External Thread Form Industrial

POLES

2=2Poles+Ground

THREAD

00=External Thread

COVER COLOR

N=Black Cover G=Gray Cover T=Transparent

CIRCUIT

see page 33

VOLTAGE & LED COLOR

see page 33

GROUND POSITION

0=Unmounted 2=H12 6=H6

SCREW & GASKET

R=Integrated NBR Gasket & IP67 Screw, S=Integrated Silicone Gasket & IP67 Screw

PACKAGING STYLE

no digit=Single Bag Unmounted, SN=Bulk Pack Mounted, CN=Bulk Pack Unmounted

mPm® Field Attachable DIN Valve Connectors

121202 Form Industrial,
Ext. Thread, Non-Electronic

121208 Form Industrial,
Ext. Thread, Electronic

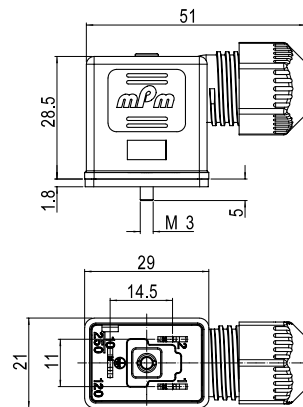
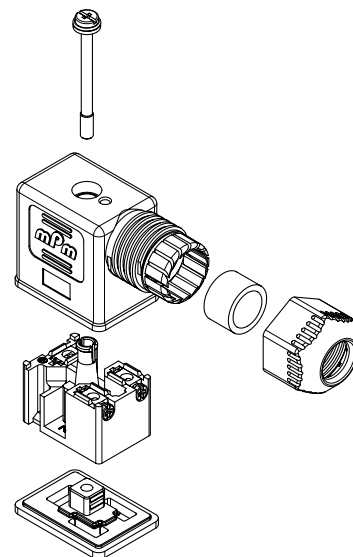

Note: UL listed part number identified by adding suffix SA at the end of the nomenclature in conjunction with UL material (W for black and T for transparent) e.g. C28200W2RSNSA

Build your connector using the intelligent part number system and contact your local sales representative to identify the proper EDP number to use in your purchase orders

Packaging Type		Poles	Circuit	Voltage	LED Color	Engineering No.	Standard Order No.
Single Bag	Unmounted	2+Ground	NO	250V AC/300V DC	NO	C22200N0R	1212020001
Bulk Pack	Mounted		NO	250V AC/300V DC	NO	C22200N2RSN	1212020012
Single Bag	Unmounted		C4	24V AC/DC	yellow	S22200TC4H0R	1212080080
Bulk Pack	Mounted		C4	24V AC/DC	yellow	S22200TC4H2RSN	1212080240
Single Bag	Unmounted		C4	230V AC/DC	yellow	S22200TC4M0R	1212080083
Bulk Pack	Mounted		C4	230V AC/DC	yellow	S22200TC4M2RSN	1212080243