

42BL Brushless Motor

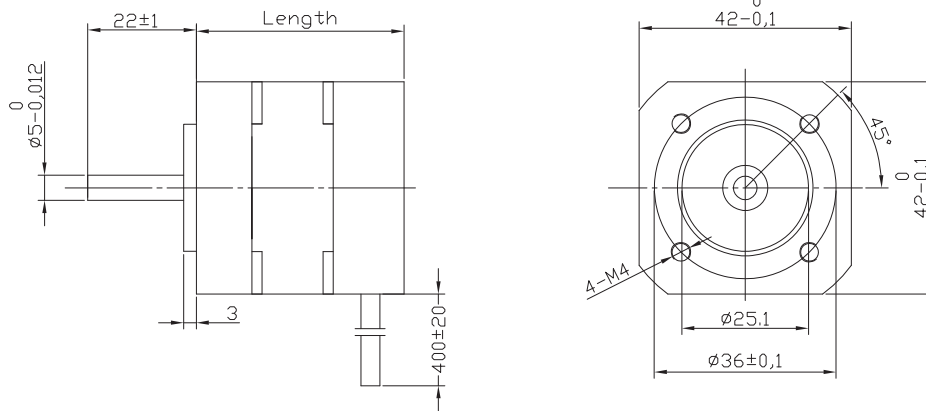

Characteristics

HALL EFFECT ANGLE
120 ° ELECTRIC ANGLE

SHAFT RUN OUT
0,025 MM

INSULATION CLASS
B

RADIAL PLAY
0,02 MM 450G LOAD

AXIAL PLAY
0,08 MM 450G LOAD

MAX RADIAL FORCE
28 N (10 MM FROM FLANGE)

MAX AXIAL FORCE
10 N

DIELECTRIC STRENGTH
500 VDC FOR ONE MINUTE

MAX AXIAL FORCE
100 M OHM MIN. 500 VDC

Specification

Model		42BL41	42BL61	42BL81	42BL100
1	N° OF POLE	8	8	8	8
2	N° OF PHASE	3	3	3	3
3	RATED VOLTAGE	V	24	24	24
4	RATED SPEED	RPM	4000	4000	4000
5	RATED TORQUE	NM	0,0625	0,125	0,185
6	MAX PEAK TORQUE	NM	0,19	0,38	0,56
7	TORQUE CONSTANT	NM/A	0,035	0,036	0,036
8	LINE TO LINE RESISTANCE	Ω	1,8	0,72	0,55
9	LINE TO LINE INDUCTANCE	MH	2,6	1,2	0,8
10	MAX PEAK CURRENT	A	5,4	10,6	15,5
11	LENGTH	MM	41	61	81
12	ROTOR INERTIA	G-CM ²	24	48	72
13	WEIGHT	KG	0,3	0,45	0,65

Connection

LEAD N°	COLOR	GAUGE	FUNCTION
1	RED	UL1430 AWG26	VCC HALL SENSOR +5 TO +24 VDC
2	BLUE	UL1430 AWG26	HALL A
3	GREEN	UL1430 AWG26	HALL B
4	WHITE	UL1430 AWG26	HALL C
5	BLACK	UL1430 AWG26	GND HALL SENSOR GROUND
6	YELLOW	UL1430 AWG20	PHASE U
7	RED	UL1430 AWG20	PHASE V
8	BLACK	UL1430 AWG20	PHASE W