

# Brushless Motor 45BLW27

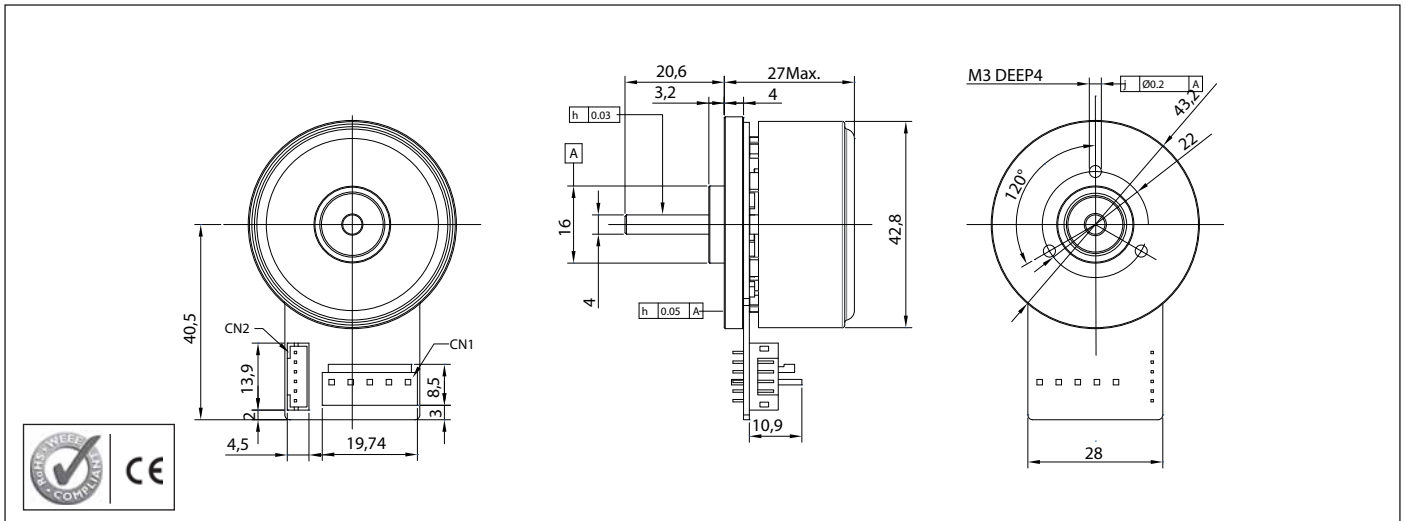

## Characteristics

HALL EFFECT ANGLE	120 ° electric angle
SHAFT RUN OUT	0,03 mm
INSULATION CLASS	B
RADIAL PLAY	0,02 mm 450g load
AXIAL PLAY	0,08 mm 450g load
MAX RADIAL FORCE	28N 10mm from flange
MAX AXIAL FORCE	10N
DIELECTRIC STRENGTH	500 VDC for one minute
INSULATION RESISTANCE	100 M ohm min. 500 VDC

## Connection

PIN N°	CONNECTOR	FUNCTION
1	JST B5P	GND
2	JST B5P	Phase 1
3	JST B5P	Phase 2
4	JST B5P	Phase 3
5	JST B5P	GDN
1	JST B6B	GDN
2	JST B6B	+ 5V DC
3	JST B6B	Hall A
4	JST B6B	Hall B
5	JST B6B	Hall C
6	JST B6B	GND

## Specification

Model	45BLW27	
1 N° OF POLE		16
2 N° OF PHASE		3
3 RATED VOLTAGE	V	24
4 RATED SPEED	RPM	4840
5 RATED TORQUE	Nm	0,13
6 MAX PEAK TORQUE	Nm	0,36
7 TORQUE CONSTANT	Nm/A	0,037
8 LINE TO LINE RESISTANCE	Ω	0,61
9 LINE TO LINE INDUCTANCE	mH	0,47
10 MAX PEAK CURRENT	A	10
11 LENGTH	MM	27
12 ROTOR INERTIA	G-CM <sup>2</sup>	180
13 WEIGHT	KG	0,15