

Brushless Motor 57HBL

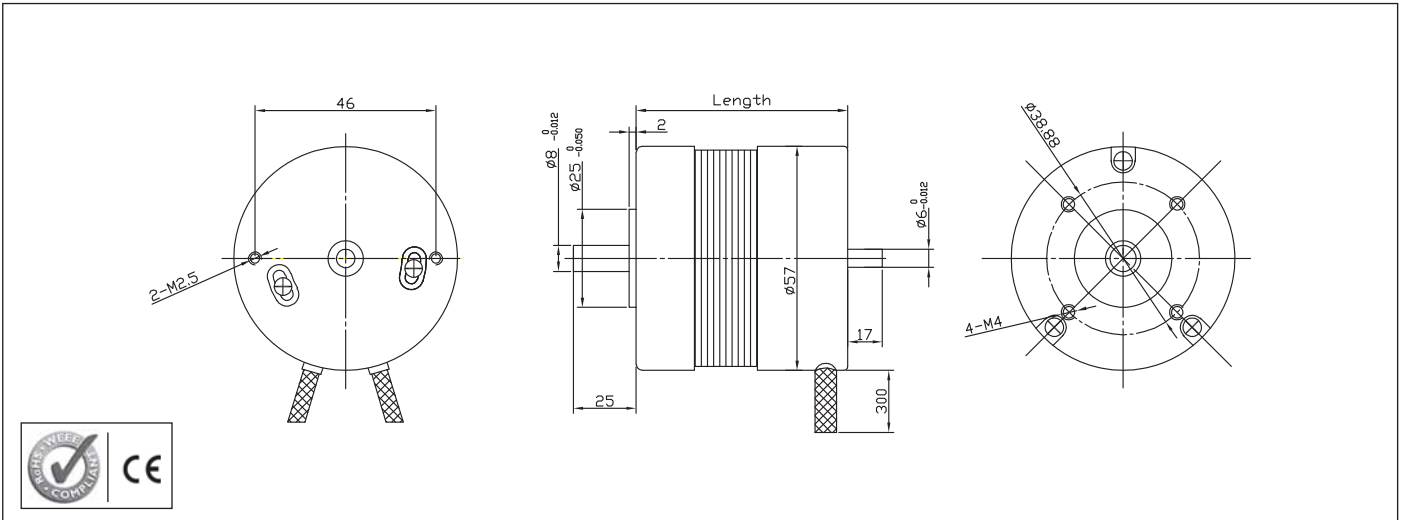

Characteristics

HALL EFFECT ANGLE
120 ° ELECTRIC ANGLE

SHAFT RUN OUT
0,025 MM

INSULATION CLASS
B

RADIAL PLAY
0,02 MM 450G LOAD

AXIAL PLAY
0,08 MM 450G LOAD

MAX RADIAL FORCE
75 N (10 MM FROM FLANGE)

MAX AXIAL FORCE
15 N

DIELECTRIC STRENGTH
500 VDC FOR ONE MINUTE

INSULATION RESISTANCE
100 M OHM MIN. 500 VDC

Specification

Model	57HBL54	57HBL74
1 N° OF POLE	8	8
2 N° OF PHASE	3	3
3 RATED VOLTAGE V	36	36
4 RATED SPEED RPM	4000	4000
5 RATED TORQUE NM	0,22	0,44
6 MAX PEAK TORQUE NM	0,6	1,2
7 TORQUE CONSTANT Nm/A	0,065	0,061
8 LINE TO LINE RESISTANCE Ω	0,72	0,51
9 LINE TO LINE INDUCTANCE mH	0,97	0,59
10 MAX PEAK CURRENT A	9	16
11 LENGTH MM	53,6	73,6
12 ROTOR INERTIA g-cm ²	75	119
13 WEIGHT KG	0,5	0,75

Connection

LEAD N°	COLOR	GAUGE	FUNCTION
1	RED	UL1332 AWG22	Vcc HALL SENSOR +5 TO +24 VDC
2	BLUE	UL1332 AWG22	HALL A
3	GREEN	UL1332 AWG22	HALL B
4	WHITE	UL1332 AWG22	HALL C
5	BLACK	UL1332 AWG22	GND HALL SENSOR GROUND
6	YELLOW	UL1332 AWG18	PHASE U
7	RED	UL1332 AWG18	PHASE V
8	BLACK	UL1332 AWG18	PHASE W