



- H2D load cells are available for manifold accurate measurement in the capacities 5t~20t.
- Alloy steel, sealed by adhesive, oil-proof, waterproof and anti-corrosion, suitable for all kinds of environments.
- Spoke type, easy installation, suitable for crane scale, hopper scale and other electronic weighing devices.
- Safe and anti-explosive product, can be used in atrocious environment and hazardous areas.

### Features

- Capacity: 5t~20t
- Alloy steel construction
- High accuracy

### Specifications

Capacity	t	5/10/20		
		C1	C2	C3
Accuracy				
Maximum number of verification intervals	n <sub>max</sub>	1000	2000	3000
Minimum load cell verification interval	v <sub>min</sub>	E <sub>max</sub> /3000	E <sub>max</sub> /5000	E <sub>max</sub> /7500
Combined error	(%FS)	≤ ±0.050	≤ ±0.030	≤ ±0.020
Creep	(%FS/30min)	≤ ±0.038	≤ ±0.023	≤ ±0.016
Temperature effect on sensitivity	(%FS/10°C)	≤ ±0.028	≤ ±0.017	≤ ±0.011
Temperature effect on zero	(%FS/10°C)	≤ ±0.047	≤ ±0.029	≤ ±0.019
Output sensitivity	(mv/v)	2.0 ± 0.008		
Input resistance	(Ω)	750 ± 10		
Output resistance	(Ω)	700 ± 5		
Insulation resistance	(MΩ)	≥ 5000(50VDC)		
Zero balance	(%FS)	1.0		
Temperature, compensated	(°C)	-10 ~ +40		
Temperature, operating	(°C)	-35 ~ +65		
Excitation, recommended	(V)	5 ~ 12(DC)		
Excitation, max	(V)	18(DC)		
Safe overload	(%FS)	150		
Ultimate overload	(%FS)	300		

### Outline Dimension mm(inch)

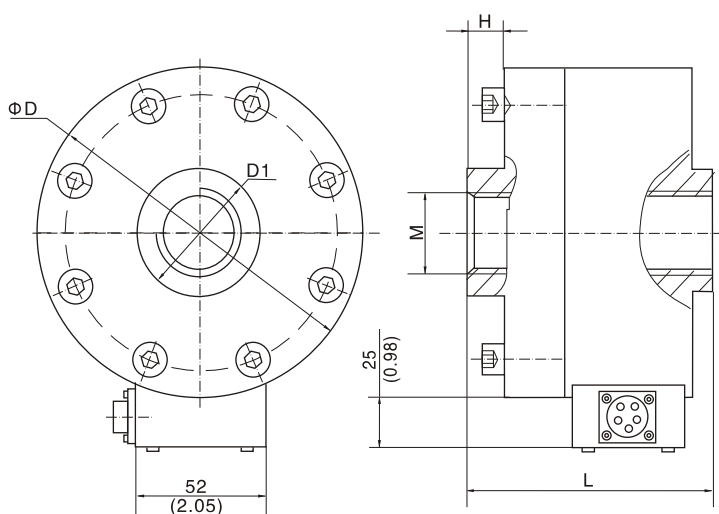

Capacity (t)	Dimension (mm)				
	L	D	D1	M	H
5	83 (3.27)	128 (5.04)	45 (1.77)	M24×2	8 (0.31)
10	150 (5.91)	160 (6.03)	60 (2.36)	M39×2	30 (1.18)
20	220 (8.66)	200 (7.78)	80 (2.99)	M60×2	60 (2.36)

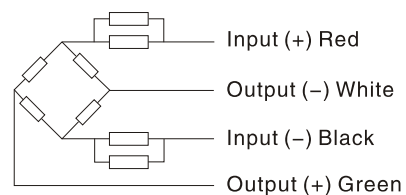

### Wiring:

Five-wire connector  
Adopt shielded, 4 conductor cable: Φ5mm  
Standard cable length: 5m(5,10t), 10m(20t)