



K-FSS-6.4-4 (Form 4)

The K Lock is a key operated mechanical bolt interlock that is suitable for the control of electrical switchgear. The standard unit comes with a 15.88 mm diameter bolt available in various lengths, that is used to control the rotation or movement of operating handles or toggles of electrical switchgear. Many suppliers of switchgear equipment have mounting kits available for Castell's interlocks. The lock is manufactured in brass or stainless steel making it ideal for use in harsh or corrosive environments.

Operation

The Castell Bolt Interlock range is used in switchgear control to inhibit movement of cams, toggles or levers.

K Bolt Interlock, Form 4

① Key is free, bolt is extended



② Insert and turn key to drive bolt

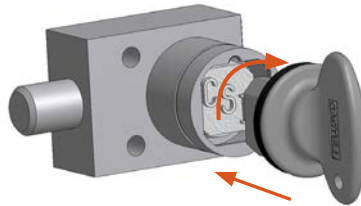

③ Key is trapped, bolt is retracted



1. While the side bolt is extended, the key is free. The mechanism is locked.
2. By inserting and turning the key in the bolt interlock, you can retract the bolt, releasing the disconnecter. This will trap the key into the lock.
3. The key stays trapped while the bolt is retracted.

The length of the bolt is available in various lengths to suit the application, but the travel of the bolt is always 19,05 mm. The key is free when the bolt is extended. Insertion and rotation clockwise of the key will retract the bolt. The key will be trapped in the bolt retracted position.

Technical Data

Temperature rating	Minimum: -40°C [-40°F] ice free for Q & FS Type
	Maximum: 107°C [224,6°F] for Q Type/140°C [284°F] for FS Type
Type of mounting	M8 (brass), Ø8,35mm (stainless steel), Ø10,3mm (US standard brass/stainless steel)
Weight	Brass: 0,7 kg
	Stainless steel: 0,7 kg
Material	Brass/Stainless steel
MTTF Certification	Available on request

Application

The power supply to the system is switched on and the access doors to the hazardous area are locked closed. Key A is trapped in the disconnecter K Lock while the process is on.

To enter the area, the disconnecter is turned to the off position and key A is released, locking the disconnecter in the disengaged position.

Key A is then taken to the grounding switch. Key A enters the K lock which retracts the bolt enabling the cammed switch lever to be rotated to engage the ground. Once rotated, the recess in the cam aligns with the second K lock. Key B from the second K lock can now be removed which now locks the lever in place ensuring that the ground connection cannot be broken.

Now that the system is disconnected and grounded, key B can be released to operate the access interlock and gain access to the dangerous area.

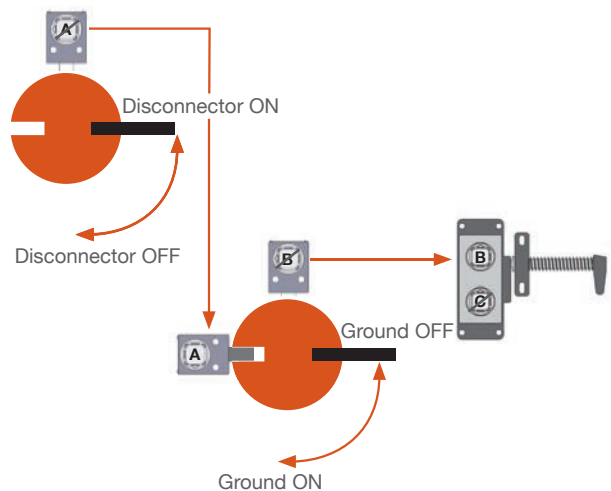

EC-Declaration

We, the manufacturers, declare that the components, detailed herein and placed on the market, comply with all the essential health and safety requirements applying to them.

Empowered signatory:

Mr T.C. Whelan
Managing Director



Drawing

Dimensions:
in mm

Note: For safe mounting, use security screws

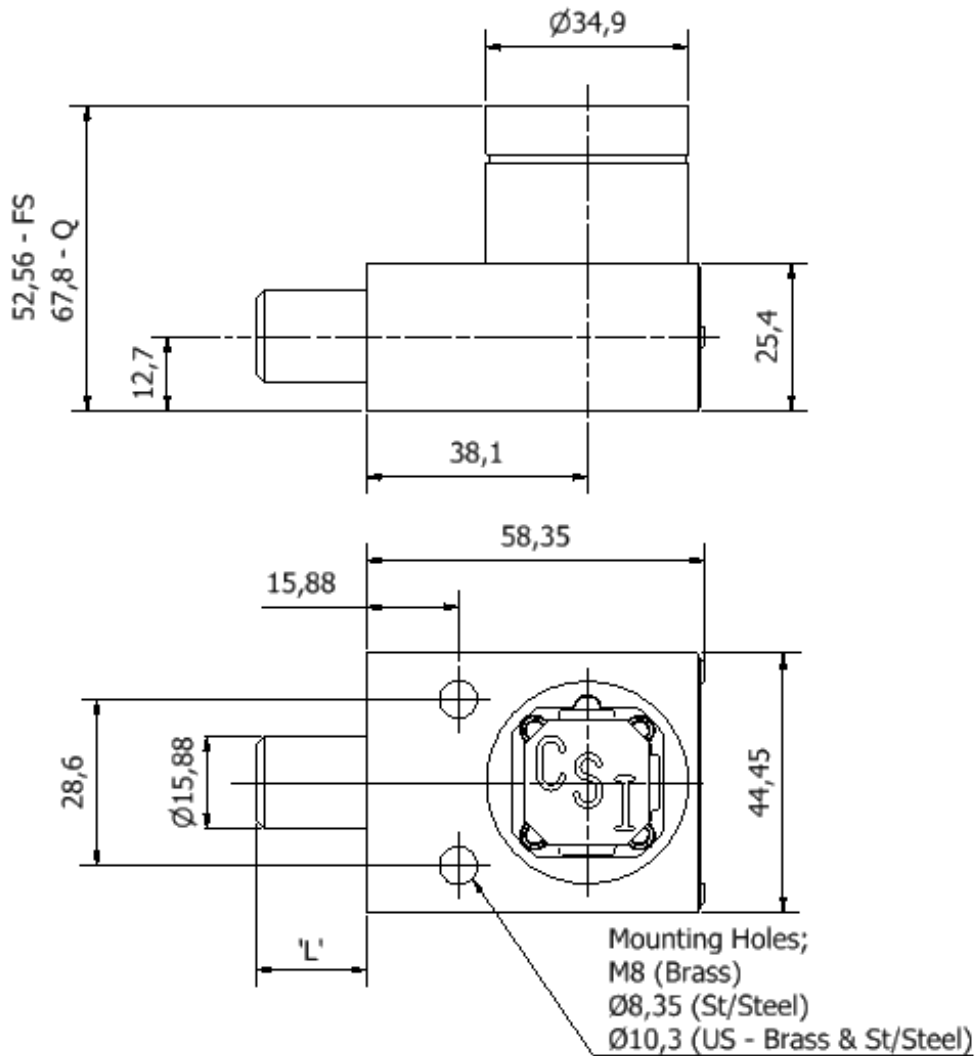

L Dimension Retracted bolt length (in mm)	Extended bolt length (in mm)
0	19,05
6,35	25,40
12,70	31,75
19,05	38,10
25,40	44,45

Order Information

	Product Type	1	2	3	4
Part Number	K				
Example	K	FS	B	6,4	1
	5				
	ABC				

1	Lock portion type	FS ⁽¹⁾ / Q ⁽¹⁾
2	Material	B = Brass / S = Stainless steel
3	L Dimension (bolt length when retracted) in mm	0 / 6,4 / 12,7 / 19,1 / 25,4
4	Form	1 / 2 / 3 / 4 ⁽²⁾
5	Lock portion symbol	FS ⁽¹⁾ up to 3 digits / Q ⁽¹⁾ up to 6 digits

(1) **FS - Lock type**
Up to 3 symbols

Q - Lock type
Up to 6 symbols

(2) **Form**

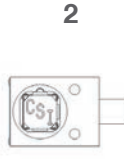

Special construction available upon enquiry

Accessories

	Product	Part number
	Flip Cap	FLIP-S

Contact Information

Castell Safety International Ltd.
The Castell Building
217 Kingsbury Road
London, England NW9 9PQ

Castell Safety International Ltd.
Oskar-Jäger-Strasse 137
50825 Köln
Germany

Castell Interlocks Inc.
21, Kenton Lands Road
Erlanger, KY 41018
United States of America

Castell Safety China
Building 1, No. 123,
Lane 1165, Jindu Road,
Minhang District,
Shanghai 201108, China.

t: +44 (0) 20 8200 1200
f: +44 (0) 20 8905 9378
e: uksales@castell.com

t: +49 (0) 221 1649 794
f: +49 (0) 221 1649 795
e: eusales@castell.com

t: +1.859.341.3075
f: +1.859.957.1577
e: ussales@castell.com

t: +86 21 61519023
f: +86 21 61519030
e: chinasales@castell.com

While every effort has been made to ensure the accuracy of the information provided, no liability can be taken for any errors or omission. Castell Safety International Limited reserves the right to alter specifications and introduce improvements without prior notice.