

Level Switch NM-007HP



- Cover or base mounting for monitoring max. or min. level
- Normally closed or normally open contact

Characteristics

Mechanical level monitor for fluid media, with contact-free triggering of a reed contact.

Technical data

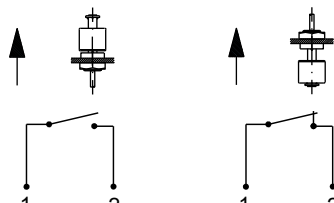
Switch	reed switch
Process connection	male thread Pg 7
Density of medium	$\geq 0.8 \text{ g/cm}^3$
Pressure resistance	PN 5 bar
Medium temperature	-20...+60 °C
Ambient temperature	-20...+60 °C
Media	water, oil
Wiring	<p>'normally open' or 'normally closed' No. 0.442</p>  <p>The switching function can be modified by changing the float.</p>
Switching voltage	max. 230 V AC

Switching current	max. 0.5 A
Switching capacity	max. 10 VA
Protection class	2 - safety insulation
Ingress protection	IP 65
Electrical connection	cabl 1.5 m
Materials medium-contact	PP
Non-medium-contact materials	PA, PVC
Weight	0.04 kg
Installation location	vertical installation position

Dimensions

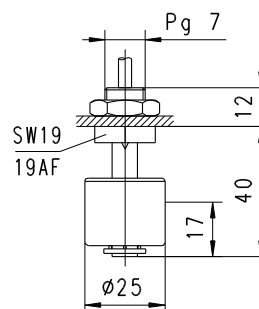

Details of float location 17 mm for density 1 g/cm³.
The device is delivered without a seal.

Handling and operation

- It must be ensured that the values given for voltage, current, and power are not exceeded.
- When switched on, a load must be connected in series.
- The electrical details apply to ohmic loads. Capacitive, inductive and lamp loads must be operated using a protective circuit.
- Not suitable for use in media with ferritic particles.

Ordering code

NM - 1. 007 2. H 3. P

1. Connection size	007	threaded connection Pg 7
2. Process connection	H	screw-in thread
3. Connection material	P	PP