

Level Switch NMS-004HM47



- Cover or base mounting for monitoring max. or min. level
- Normally closed or normally open contact

Characteristics

Mechanical level monitor for fluid media, with contact-free triggering of a reed contact.

Technical data

Switch	reed switch
Process connection	male thread G 1/8 A
Density of medium	$\geq 0.4 \text{ g/cm}^3$
Pressure resistance	PN 12 bar
Medium temperature	-20...+105 °C
Ambient temperature	-20...+55 °C
Media	water, oils
Wiring	<p>'normally open' or 'normally closed' No. 0.442</p> <p>the switching function can be modified by changing the float.</p>
Switching voltage	max. 300 V AC
Switching current	max. 0.5 A
Switching capacity	max. 70 VA

Protection class	2 -safety insulation
Ingress protection	IP 65
Electrical connection	cabl 1.5 m
Materials medium-contact	CW614N, Spansil (NBR), bronze
Non-medium-contact materials	PVC
Weight	0.065 kg
Installation location	vertical installation position

Dimensions

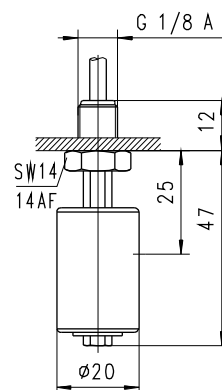

Details of float location 25 mm for density 1 g/cm³.
The device is delivered without a seal.

Handling and operation

- It must be ensured that the values given for voltage, current, and power are not exceeded.
- When switched on, a load must be connected in series.
- The electrical details apply to ohmic loads. Capacitive, inductive and lamp loads must be operated using a protective circuit.
- Not suitable for use in media with ferritic particles.

Ordering code

1. 2. 3. 4.
NMS - 004 H M 047

○=Option

1.	Connection size	
	004	threaded connection G 1/8 A
2.	Process connection	
	H	screw-in thread
3.	Connection material	
	M	brass
4.	Length	
	047	47 mm

... professional Instruments "MADE IN GERMANY"