

# BASIC M30

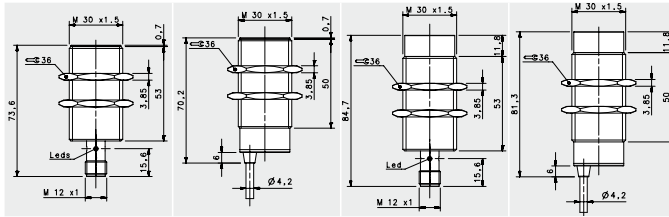

## STANDARD

FLUSH		NON FLUSH	
-------	--	-----------	--

M12 conn	cable	M12 conn	cable
----------	-------	----------	-------

### NOMINAL SWITCHING DISTANCE

				10 mm	10 mm	15 mm	15 mm
10-30 Vdc	PNP/NPN NO-NC	4 wires	order No.	IS-30-A0-S2 95B064490	IS-30-A0-03 95B064460	IS-30-C0-S2 95B064510	IS-30-C0-03 95B064470
10-30 Vdc	PNP NO	3 wires	order No.	IS-30-A1-S2 95B061431	IS-30-A1-03 95B061421	IS-30-C1-S2 95B061831	IS-30-C1-03 95B061821
10-30 Vdc	PNP NC	3 wires	order No.	IS-30-A2-S2 95B061451	IS-30-A2-03 95B061441	IS-30-C2-S2 95B061851	IS-30-C2-03 95B061841
10-30 Vdc	NPN NO	3 wires	order No.	IS-30-A3-S2 95B061391	IS-30-A3-03 95B061381	IS-30-C3-S2 95B061791	IS-30-C3-03 95B061781
10-30 Vdc	NPN NC	3 wires	order No.	IS-30-A4-S2 95B061411	IS-30-A4-03 95B061401	IS-30-C4-S2 95B061811	IS-30-C4-03 95B061801
10-30 Vdc	PNP NO-NC	3 wires	order No.	---	---	---	---
10-30 Vdc	NPN NO-NC	3 wires	order No.	---	---	---	---
10-30 Vdc	NO-NC	2 wires	order No.	IS-30-A9-S2 95B064570	IS-30-A9-03 95B064530	IS-30-C9-S2 95B064590	IS-30-C9-03 95B064550
20-250 Vac/Vdc	NO	2 wires	order No.	---	---	---	---
20-250 Vac/Vdc	NC	2 wires	order No.	---	---	---	---
20-250 Vac/Vdc	NO	2/3 wires	order No.	---	---	---	---
Analog 0-20mA	-	3 wires	order No.	---	---	---	---
5+24 Vdc	NAMUR	2 wires	order No.	---	---	---	---

	10-30 Vdc (-15/10%)	10-30 Vdc (-15/10%)	10-30 Vdc (-15/10%)	10-30 Vdc (-15/10%)
Nominal Voltage	10-30 Vdc (-15/10%)	10-30 Vdc (-15/10%)	10-30 Vdc (-15/10%)	10-30 Vdc (-15/10%)
Residual Ripple	< 10%	< 10%	< 10%	< 10%
Hysteresis	< 10%	< 10%	< 10%	< 10%
Max. Output Current	200mA; 100 mA (2wires)	200mA; 100 mA (2wires)	200mA; 100 mA (2wires)	200mA; 100 mA (2wires)
Min. Output Current	> 1,6 mA (2wires)	> 1,6 mA (2wires)	> 1,6 mA (2wires)	> 1,6 mA (2wires)
Residual Current	< 1,6 mA	< 1,6 mA	< 1,6 mA	< 1,6 mA
Voltage Drop	< 1,8V; < 6,5 V (2wires)	< 1,8V; < 6,5 V (2wires)	< 1,8V; < 6,5 V (2wires)	< 1,8V; < 6,5 V (2wires)
Operation Led	Yellow	Yellow	Yellow	Yellow
Switching Frequency	300 Hz	300 Hz	300 Hz	300 Hz
Start Up Delay	< 50 ms	< 50 ms	< 50 ms	< 50 ms
Repeatability	< 3%	< 3%	< 3%	< 3%
Short Circuit Protection	Present (self-resetting) Against polarity reversal inductive loads	Present (self-resetting) Against polarity reversal inductive loads	Present (self-resetting) Against polarity reversal inductive loads	Present (self-resetting) Against polarity reversal inductive loads
Electric Protection	Present (self-resetting) Against polarity reversal inductive loads	Present (self-resetting) Against polarity reversal inductive loads	Present (self-resetting) Against polarity reversal inductive loads	Present (self-resetting) Against polarity reversal inductive loads
Temperature Limit	(-25 ... +70 °C)	(-25 ... +70 °C)	(-25 ... +70 °C)	(-25 ... +70 °C)
Protection Degree	IP67	IP67	IP67	IP67
Cable Length	---	2 m	---	2 m
Cable Section	---	2/3/4 x 0,25 mm <sup>2</sup>	---	2/3/4 x 0,25 mm <sup>2</sup>
Housing Material	Nickel-plated brass	Nickel-plated brass	Nickel-plated brass	Nickel-plated brass
Weight - Cable Output	---	210 g	---	210 g
Weight - M12 Connector Output	170 g	---	170 g	---

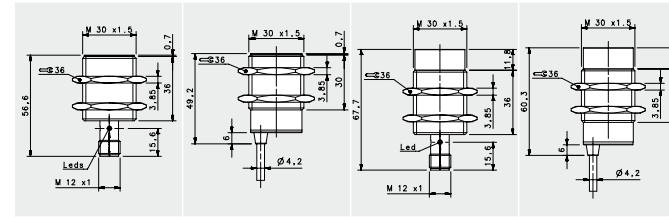

## SHORT

FLUSH		NON FLUSH	
-------	--	-----------	--

M12 conn	cable	M12 conn	cable
----------	-------	----------	-------

				10 mm	10 mm	15 mm	15 mm
10-30 Vdc (-15/10%)	PNP/NPN NO-NC	4 wires	order No.	---	---	---	---
10-30 Vdc (-15/10%)	PNP NO	3 wires	order No.	IS-30-B1-S2 95B062231	IS-30-B1-03 95B062221	IS-30-D1-S2 95B062631	IS-30-D1-03 95B062621
10-30 Vdc (-15/10%)	PNP NC	3 wires	order No.	IS-30-B2-S2 95B062251	IS-30-B2-03 95B062241	IS-30-D2-S2 95B062651	IS-30-D2-03 95B062641
10-30 Vdc (-15/10%)	NPN NO	3 wires	order No.	IS-30-B3-S2 95B062191	IS-30-B3-03 95B062181	IS-30-D3-S2 95B062591	IS-30-D3-03 95B062581
10-30 Vdc (-15/10%)	NPN NC	3 wires	order No.	IS-30-B4-S2 95B062211	IS-30-B4-03 95B062201	IS-30-D4-S2 95B062611	IS-30-D4-03 95B062601
10-30 Vdc (-15/10%)	PNP NO-NC	3 wires	order No.	---	---	---	---
10-30 Vdc (-15/10%)	NPN NO-NC	3 wires	order No.	---	---	---	---
10-30 Vdc (-15/10%)	NO-NC	2 wires	order No.	---	---	---	---
20-250 Vac/Vdc	NO	2 wires	order No.	---	---	---	---
20-250 Vac/Vdc	NC	2 wires	order No.	---	---	---	---
20-250 Vac/Vdc	NO	2/3 wires	order No.	---	---	---	---
Analog 0-20mA	-	3 wires	order No.	---	---	---	---
5+24 Vdc	NAMUR	2 wires	order No.	---	---	---	---

	10-30 Vdc (-15/10%)	10-30 Vdc (-15/10%)	10-30 Vdc (-15/10%)	10-30 Vdc (-15/10%)
Nominal Voltage	10-30 Vdc (-15/10%)	10-30 Vdc (-15/10%)	10-30 Vdc (-15/10%)	10-30 Vdc (-15/10%)
Residual Ripple	< 10%	< 10%	< 10%	< 10%
Hysteresis	< 10%	< 10%	< 10%	< 10%
Max. Output Current	200 mA	200 mA	200 mA	200 mA
Min. Output Current	---	---	---	---
Residual Current	< 10 mA	< 10 mA	< 10 mA	< 10 mA
Voltage Drop	< 1,8 V (I=100mA)	< 1,8 V (I=100mA)	< 1,8 V (I=100mA)	< 1,8 V (I=100mA)
Operation Led	Yellow	Yellow	Yellow	Yellow
Switching Frequency	300 Hz	300 Hz	300 Hz	300 Hz
Start Up Delay	< 50 ms	< 50 ms	< 50 ms	< 50 ms
Repeatability	< 3%	< 3%	< 3%	< 3%
Short Circuit Protection	Present (self-resetting) Against polarity reversal inductive loads	Present (self-resetting) Against polarity reversal inductive loads	Present (self-resetting) Against polarity reversal inductive loads	Present (self-resetting) Against polarity reversal inductive loads
Electric Protection	Present (self-resetting) Against polarity reversal inductive loads	Present (self-resetting) Against polarity reversal inductive loads	Present (self-resetting) Against polarity reversal inductive loads	Present (self-resetting) Against polarity reversal inductive loads
Temperature Limit	(-25 ... +60 °C)	(-25 ... +60 °C)	(-25 ... +60 °C)	(-25 ... +60 °C)
Protection Degree	IP67	IP67	IP67	IP67
Cable Length	---	2 m	---	2 m
Cable Section	---	3 x 0,25 mm <sup>2</sup>	---	3 x 0,25 mm <sup>2</sup>
Housing Material	Nickel-plated brass	Nickel-plated brass	Nickel-plated brass	Nickel-plated brass
Weight - Cable Output	---	210 g	---	210 g
Weight - M12 Connector Output	170 g	---	170 g	---