

Ics-130/IU/QP

scale drawing

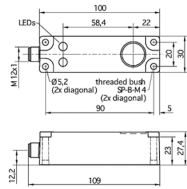

detection zone

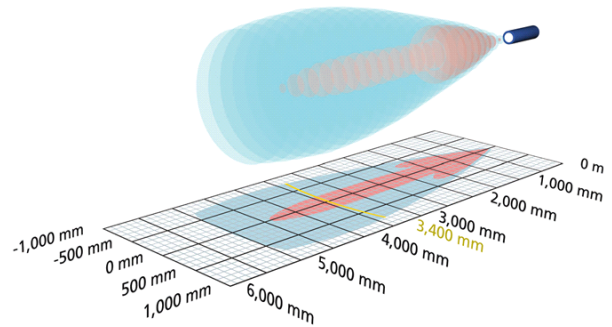

1 x analogue 4-20 mA + 0-10 V

2,000 mm

operating range	200 - 2.000 mm
design	cuboidal
operating mode	analogue distance measurements
particularities	flat housing lateral sound exit

ultrasonic -specific

means of measurement	echo propagation time measurement
transducer frequency	200 kHz
blind zone	200 mm
operating range	1,300 mm
maximum range	2,000 mm
resolution/sampling rate	0.18 mm to 0.57 mm, depending on the analogue window
reproducibility	± 0.15 %
accuracy	± 1 % (temperature drift internally compensated)

electrical data

operating voltage U_b	9 - 30 V d.c., reverse polarity protection
voltage ripple	± 10 %
Leerlaufstromaufnahme	≤ 70 mA
type of connection	5-pin M12 initiator plug

lcs-130/IU/QP

outputs

output 1	analogue output current: 4-20 mA / voltage: 0-10 V (at $U_B \geq 15$ V), short-circuit-proof switchable rising/falling
response time	110 ms
delay prior to availability	< 300 ms

inputs

input 1	com input teach-in input
---------	-----------------------------

housing

material	PBT
ultrasonic transducer	polyurethane foam, epoxy resin with glass contents
class of protection to EN 60529	IP 65
operating temperature	-20°C to +70°C
storage temperature	-40°C to +85°C
weight	200 g

technical features/characteristics

temperature compensation	yes
controls	com input control input
scope for settings	Teach-in via com input on pin 5 LCA-2 with LinkControl
Synchronisation	yes
multiplex	no
indicators	2 x three-colour LED
particularities	flat housing lateral sound exit

Ics-130/IU/QP

[documentation \(download\)](#)

pin assignment

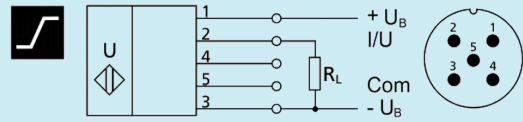

order no.

Ics-130/IU/QP