

lcs+600/IU

scale drawing

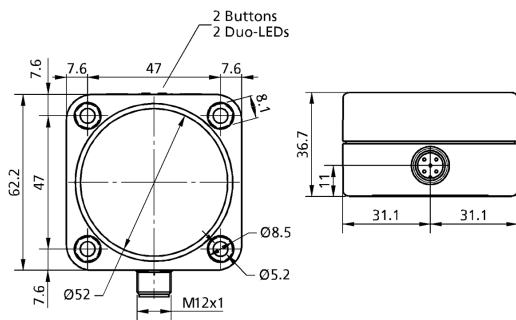

detection zone

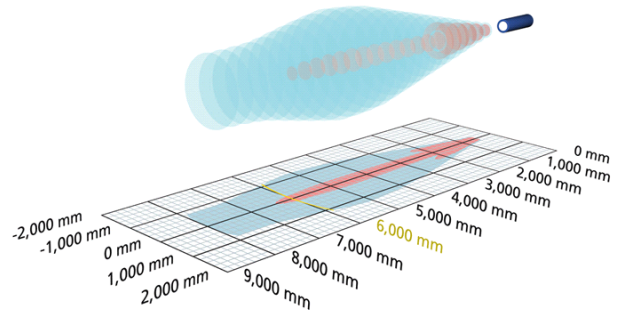

1 x analogue 4-20 mA + 0-10 V

8,000 mm

| | |
|-----------------|--------------------------------|
| operating range | 600 - 8.000 mm |
| design | cuboidal |
| operating mode | analogue distance measurements |
| particularities | UL Listed |

ultrasonic -specific

| | |
|--------------------------|---|
| means of measurement | echo propagation time measurement |
| transducer frequency | 80 kHz |
| blind zone | 600 mm |
| operating range | 6,000 mm |
| maximum range | 8,000 mm |
| resolution/sampling rate | 0.18 mm to 2.4 mm, depending on the analogue window |
| reproducibility | ± 0.15 % |
| accuracy | ± 1 % (temperature drift internally compensated) |

electrical data

| | |
|-------------------------|--|
| operating voltage U_b | 9 - 30 V d.c., reverse polarity protection |
| voltage ripple | ± 10 % |
| Leerlaufstromaufnahme | ≤ 60 mA |
| type of connection | 5-pin M12 initiator plug |

Ics+600/IU

outputs

| | |
|-----------------------------|--|
| output 1 | analogue output current: 4-20 mA / voltage: 0-10 V (at $U_B \geq 15$ V), short-circuit-proof switchable rising/falling |
| response time | 240 ms |
| delay prior to availability | < 450 ms |

inputs

| | |
|---------|------------------------------------|
| input 1 | com input synchronisation input |
|---------|------------------------------------|

housing

| | |
|---------------------------------|--|
| material | PBT |
| ultrasonic transducer | polyurethane foam, epoxy resin with glass contents |
| class of protection to EN 60529 | IP 67 |
| operating temperature | -25°C to +70°C |
| storage temperature | -40°C to +85°C |
| weight | 240 g |

technical features/characteristics

| | |
|--------------------------|--|
| temperature compensation | yes |
| controls | 2 push-buttons |
| scope for settings | Teach-in via push-button LCA-2 with LinkControl |
| Synchronisation | yes |
| multiplex | yes |
| particularities | UL Listed |

documentation (download)

pin assignment

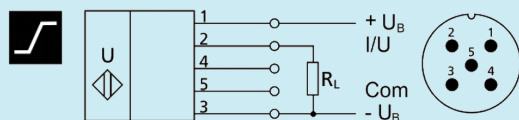

order no.

Ics+600/IU